

ODU 3IN-6D Fiber Optic Terminal Box

Instruction manual

Fiber optic terminal box is a new generation product for fiber to the home. The box is light and compact; it is especially for connecting and protection for fiber cable of FTTH.

1. Features:

It is suitable for wall-mounting installation;

It is IP65;

It is suitable for 4 fiber LC/SC duplex adapters installation and usage;

It is suitable for outdoor cable or indoor soft cable;

Size: 258×186×61mm;

The maximum capacity is 24 fibers for 4 fibers LC, and 12 fibers for duplex SC

2. Product Pictures:

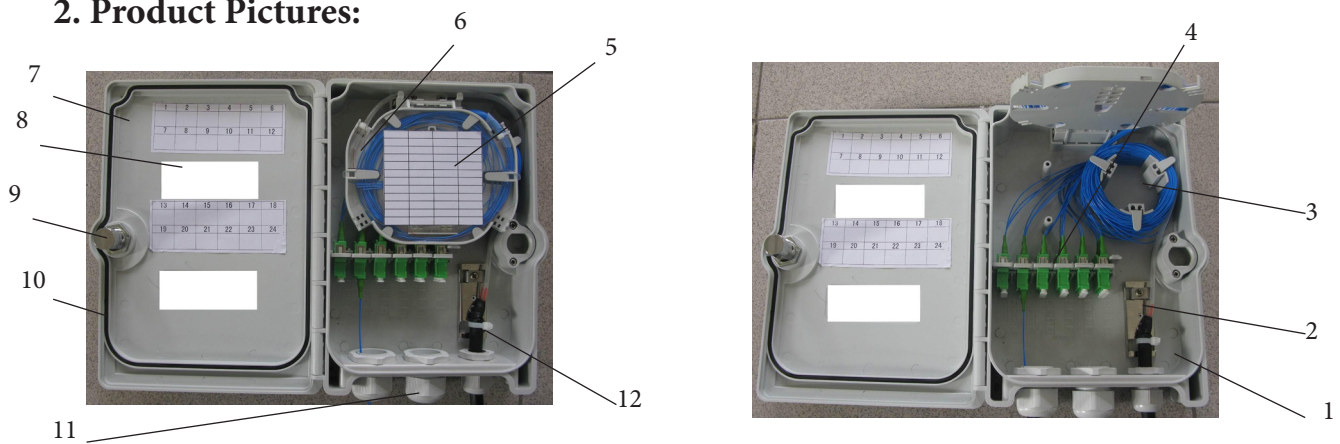

1. base; 2. fixing cable parts; 3. for coiling cable; 4. for adapter fixing; 5. splice protective sleeve; 6. splice tray; 7. cover; 8. for labeling; 9. lock; 10. sealing ring;

3. Usage :

3.1 Open the outer package of box;

3.2 Using the key, open the box;



3.3 Make the fiber cable thrill through appropriate position of box, measure the length of 120cm from the end of cable and strip the protective layers. And then use buffer tube, and wrap the insulation tape. (The below installation is the example for outdoor cable application). Put stripped cable into the cable gland, and come into the cable collar, put buffer tube on cable, and fix the steel core by tight screw. Meanwhile, adjust the nylon tie and cable gland.

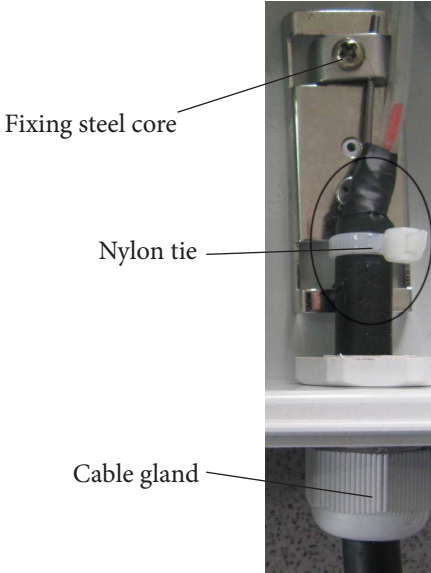

3.4 When maintained, the splice tray can be fixed on level to be operated easily. It is only need to remove right the splice tray and fix it on the slot. It is very convenience, as below pictures.

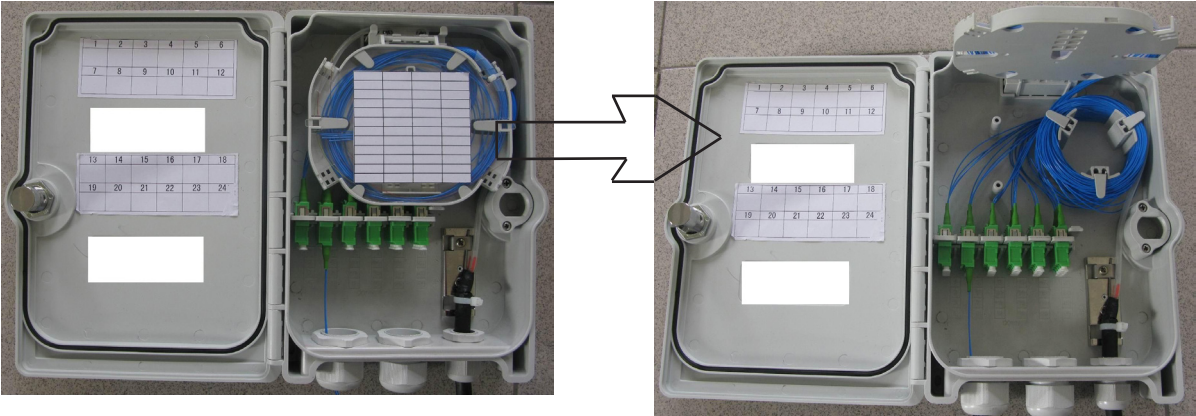

3.5 Put the adapters, insert the pigtails of splitter, then put the pigtails with tube into the splice tray, fix the pigtails by nylon tie and connect to fiber protective sleeves.(if there is optic splitter, please operate as below pictures. Drop into the splitter through splice tray, and connect adapter with pigtail.), Splicing pigtails with inlet cables, then heat the fiber protective sleeve, after heating the protective sleeve, put it into splice chip. The fiber can be coiling in the splice tray, and the other balance pigtails can be coiling in the bottom cable hoop.

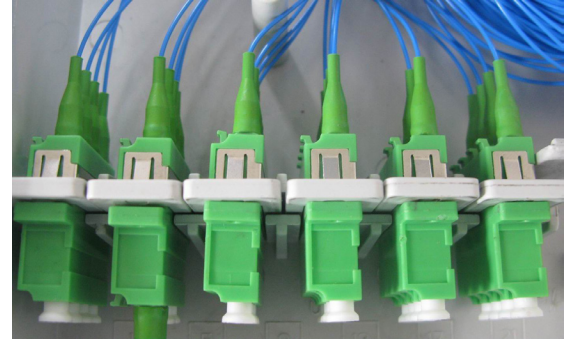
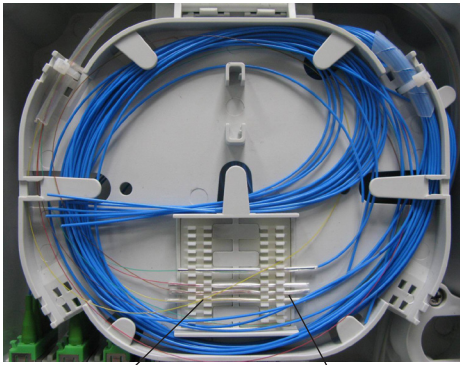

Fiber protective sleeve

Fixing here

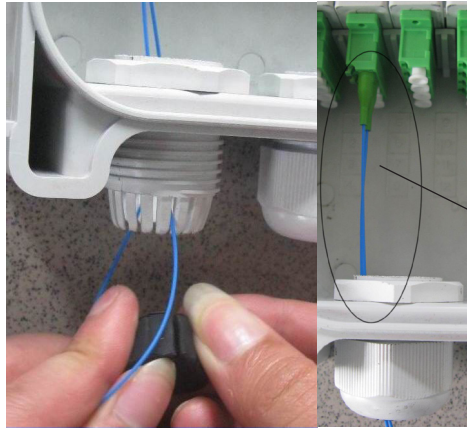

Pigtail outlet

3.6 Put down the cover



Put down the cover according this direction.
Note, it must be in vertical direction, or the cover might be destroyed.

4. Install construction

4.1 Drill the 4 holes on the wall for M4 plastic expansion screw as below pictures.

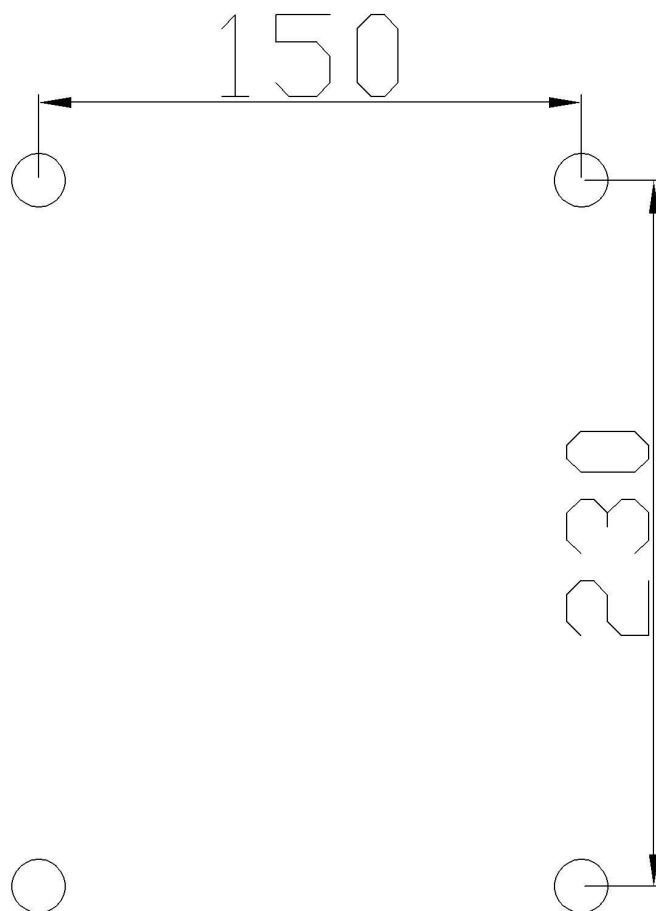

4.2 Put M4 plastic expansion screws into holes.

4.3 Mounting the box on the wall by 4×25 self-tapping screws. Cover the box, and lock it.

5. Accessories list

S/N	Name	Material spec.	Qty
1	Nylon Tie	3*120	10 pcs
2	Wall mounting kit	M4	4 pcs
3	Tapping screw	ST4*25	4 cps
4	Splice protective sleeve	0.8*45	24 pcs
5	Number paper		1pcs
6	Buffer tube	300mm	2 pcs
7	Key		2 pcs